

How to Login on the App

Our eCampus is powered by Schoology, which can be accessed on your mobile device with their iOS or Android apps. See the below links to access the correct app for you, and how to login when you have it downloaded.

[Download the iOS App](#)

[Download the Android App](#)

Logging in on iOS

Step 1: Download the app above.

Step 2: Open the app and tap on "Find your school or domain." **Do not** click on the blue "Continue."

Step 3: Type "Lancaster Bible College" into the school or domain field and tap on "Lancaster Bible College" at the top of the list.

Step 2

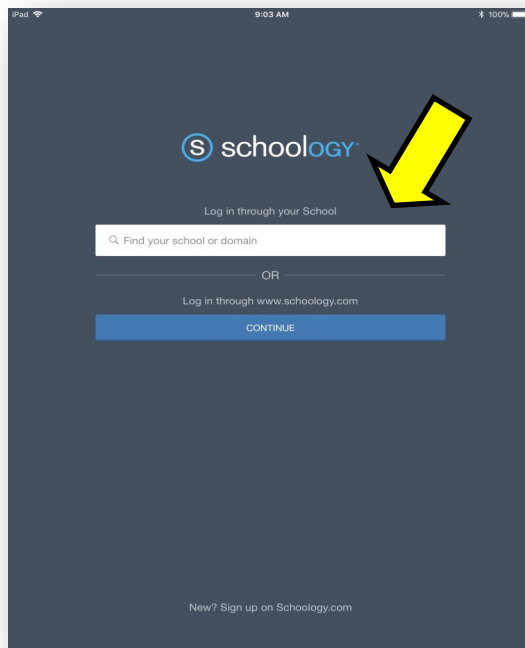

Step 3

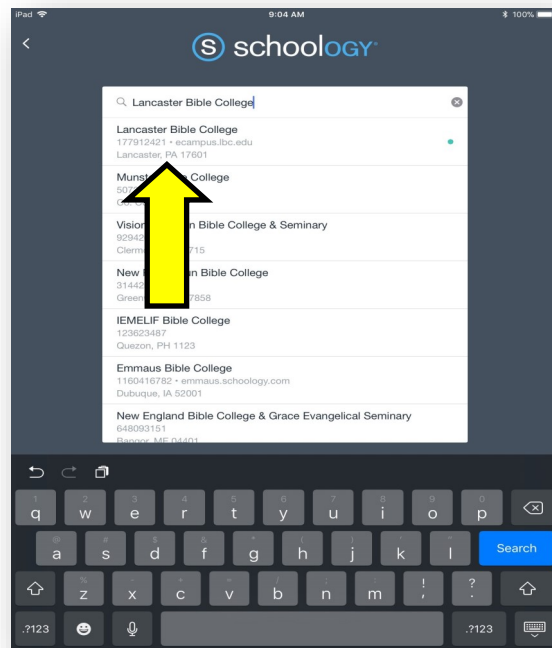

Logging in on iOS

Step 4: When "Lancaster Bible College" is selected, the app will take you to the "Sign in" page, seen below. Type in your LBC email address in the format seen in the screenshot, including the @lbc.edu on the end. Then tap "Next."

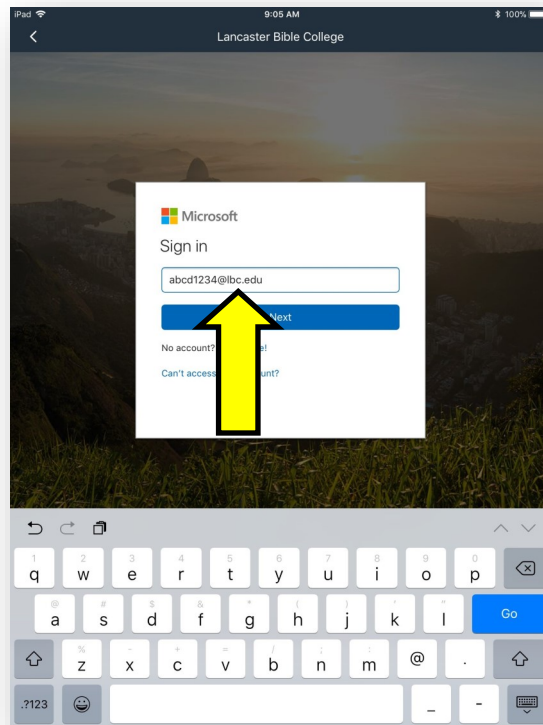

Step 5: The next page will ask you to put in your LBC password. When finished, tap "Sign in" and you will be in the app.

If you need any assistance with your LBC username or password, please contact the Help Desk at help@lbc.edu.

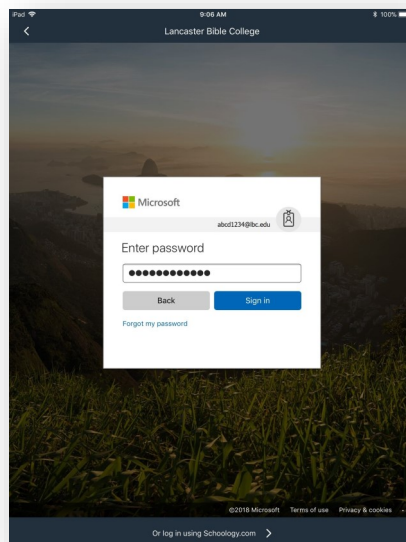

Logging in on Android

Step 1: Download the app above.

Step 2: Open the app and tap on "Find your school or domain." **Do not** click on the blue "Continue."

Step 3: Type "Lancaster Bible College" into the school or domain field and tap on "Lancaster Bible College" at the top of the list.

Step 2

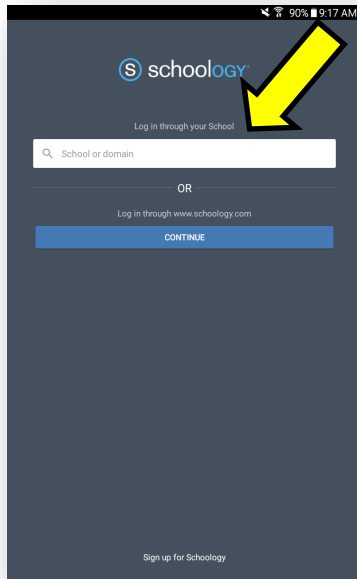

Step 3

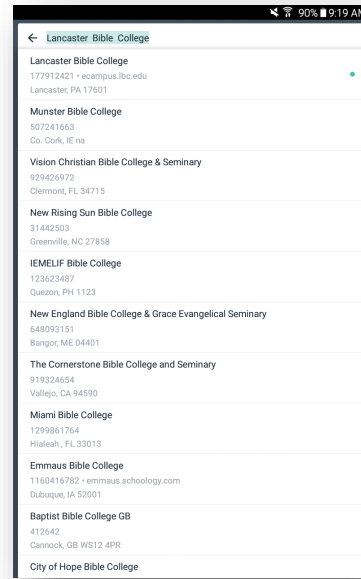

Step 4: When "Lancaster Bible College" is selected, the app will take you to the "Sign in" page, seen below. Type in your LBC email address in the format seen in the screenshot, including the @lbc.edu on the end. Then tap "Next."

Step 5: The next page will ask you to put in your LBC password. When finished, tap "Sign in" and you will be in the app.

If you need any assistance with your LBC username or password, please contact the Help Desk at help@lbc.edu.

Step 4

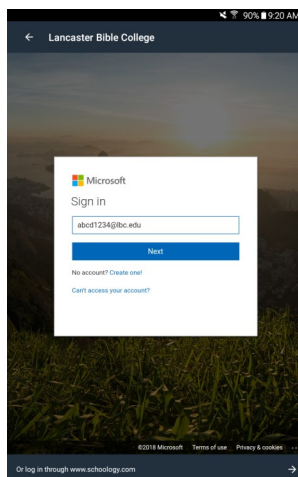

Step 5

